

# Guard Viewer P2P Quick Setup Guide

## 1. NVR SETUP:

First connect a mouse, monitor, and ethernet cable to your NVR. Left click to **cancel / exit** the startup wizard, then **right click** to **open the main menu**. Login using the default login information

**User: admin**  
**Password: 123456**



2. Navigate to **System** → **Network** → **P2P** and check the box '**Enable P2P**', then hit apply. Note the **QR code** on this page as it will be required it at a later step (see **Step #6**).

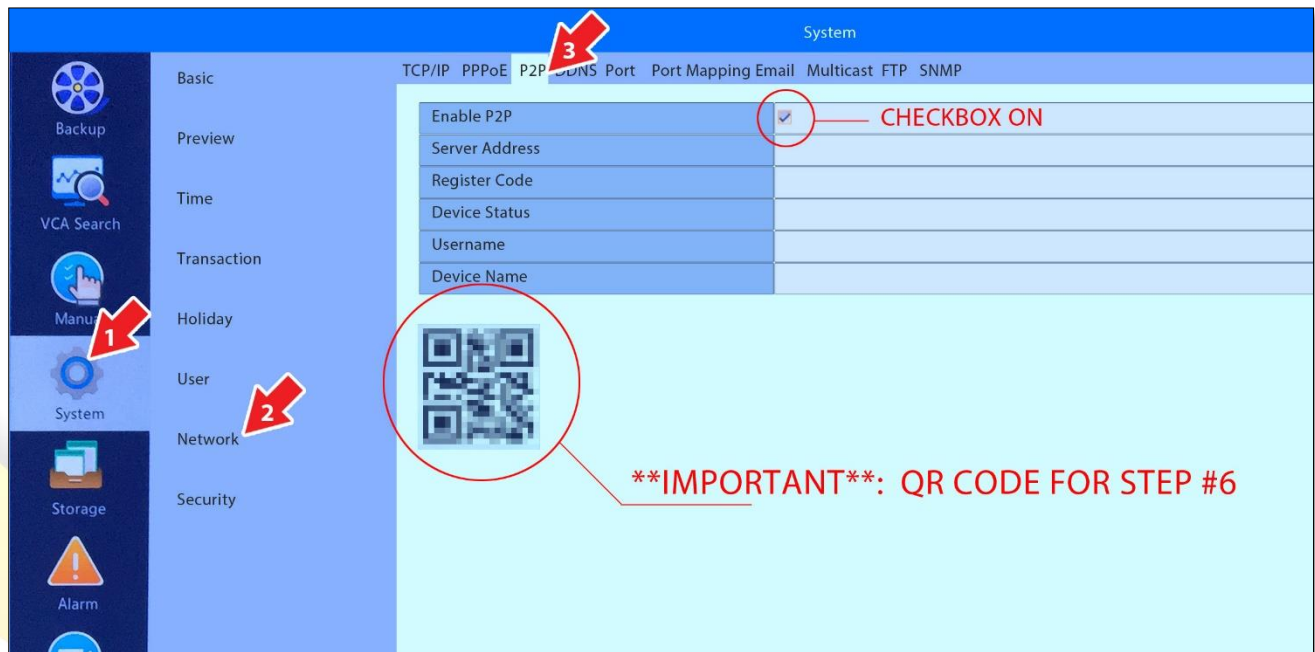

## 3. GUARD VIEWER APP SETUP:

Using your smartphone, download the **Guard Viewer** app from the App Store or Google Play Store.



4. Open the app Guard Viewer app on your smartphone and register for an account by tapping **'Sign Up'** on the bottom left.

Enter your email address then enter the verification code sent to your email. Enter a password, read and accept the terms and conditions, then click **'Sign Up'**.

You will now be logged into Guard Viewer.

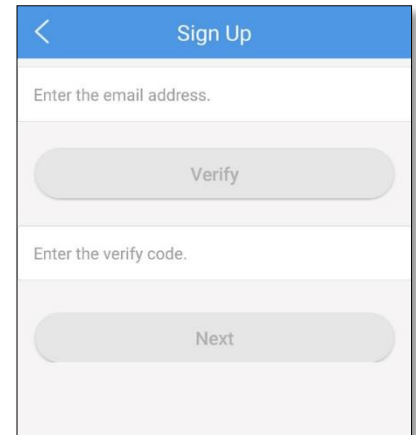

5. Navigate to the devices page and click **'+ Add'** OR **'+'** on the top right corner.

Then tap **'Scan'** and allow permission for the app to access your device's camera.

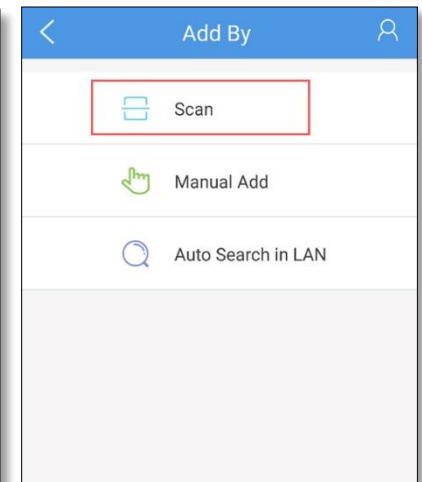
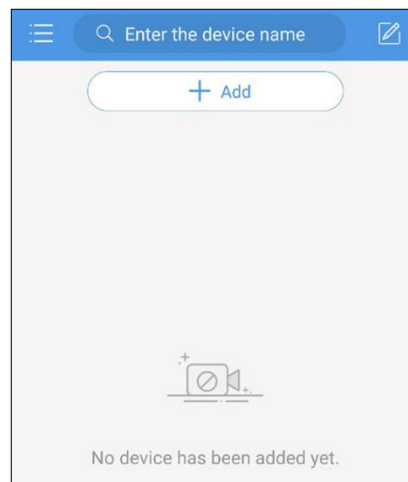

6. Scan the QR code displayed on your monitor or TV from the NVR menu from **STEP #2**.

Once scanned enter a device name and tap the save icon in the top right.

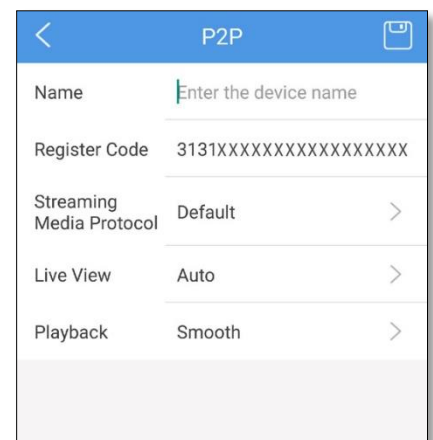

## 7. FINISHED

The device is now added to your phone and you can view any cameras connected to the NVR.